

THE FLOORING SOLUTION FOR YOUR  
**FITNESS FACILITIES**  
FREE WEIGHTS TRAINING





# OUR FLOOR FOR FREE WEIGHT TRAINING & WEIGHT LIFTING

Robust and protective:

**REGUPOL puts your customers on the best footing: Our fitness floors are slip-resistant and comfortable – a safe and secure base for training with dumbbells and free weights.**

However, our floor doesn't only support the athletes but protects the sub-base as well because, in free weight training or weight lifting, floor structures need to withstand hefty impacts. Our **REGUPOL** everroll fitness floors are incredibly resilient and impact resistant.

Do you have acoustic challenges to deal with? When it comes to impact sound, we'll be happy to develop the right acoustic solution on a project-specific basis.

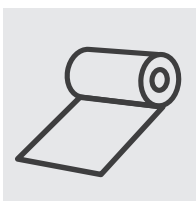

## **Rolls**

Resilient | protect the sub-base | extremely slip resistant | standard thicknesses: 8 to 12 mm

**Our products: REGUPOL everroll classic, REGUPOL everroll ultimate**

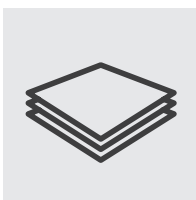

## **Multi-Layer System Build-Up**

Individual selection of protective function and comfort levels | project-specific solutions for acoustic requirements

**Our products: REGUPOL everroll impact, REGUPOL sonusfit series**



AVAILABLE

# COLOURS

## FOR FREE WEIGHTS TRAINING

**REGUPOL everroll ultimate** Available in standard or pre-sealed.

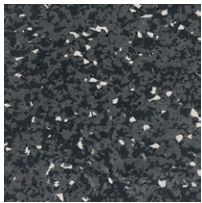

Mons [3138]  
8mm (intensity mons)

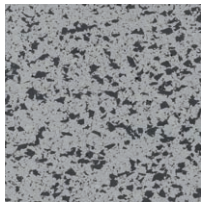

Island [3000]  
8mm (intensity island)

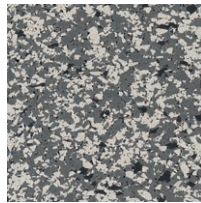

Paris [1085]  
8mm (intensity berlin)



Kush [2001]  
8mm (active kush)

**REGUPOL everroll classic** Available in standard **edition 4.0** or pre-sealed.

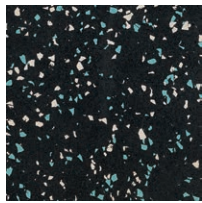

Auckland [3241]  
8mm (tone auckland)

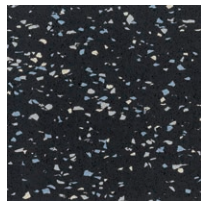

Nome [3121]  
8mm (tone nome)

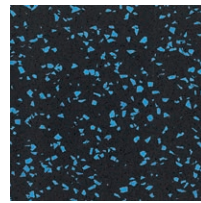

Palau [3031]  
8mm (core palau)



Sydney [3240]  
8mm (tone sydney)



Bern [3122]  
8mm (tone berlin)

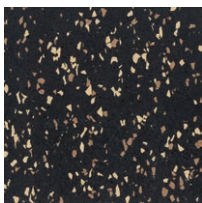

Kush [3118]  
8mm (tone kush)

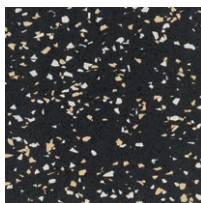

Lhasa [3180]  
8mm (tone lhasa)

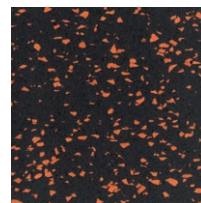

Amsterdam [3145]  
8mm (core amsterdam)

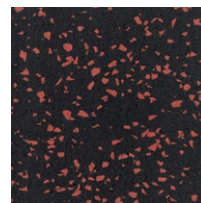

Goa [3033]  
8mm (core goa)

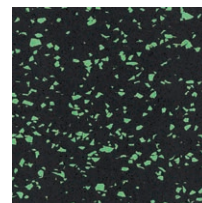

Manaus [3032]  
8mm (core manaus)

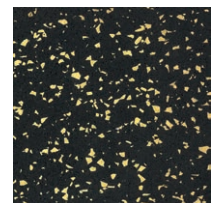

Melbourne [3029]  
8mm (core melbourne)

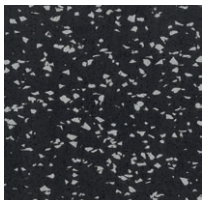

Berlin [3030]  
8 | 12mm (core berlin)



Mons [3256]  
8 | 12mm (core mons)



Perth [3239]  
8mm (tone perth)

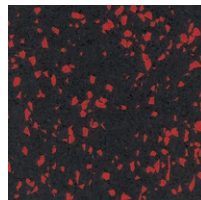

Marrakech [3276]  
8mm (core marrakech)

**edition 4.0** = brilliant colours and nonreflecting surface  
(brackets show superceeded product name)



Deviations from the colours shown are possible due to production batches and brochure print.

# FREE WEIGHT TRAINING AREAS

This system reflects a typical application with **REGUPOL everroll** floor coverings. For all other applications please contact the **REGUPOL** sports division. Please note that drawings are not to scale and are for illustration purposes only.

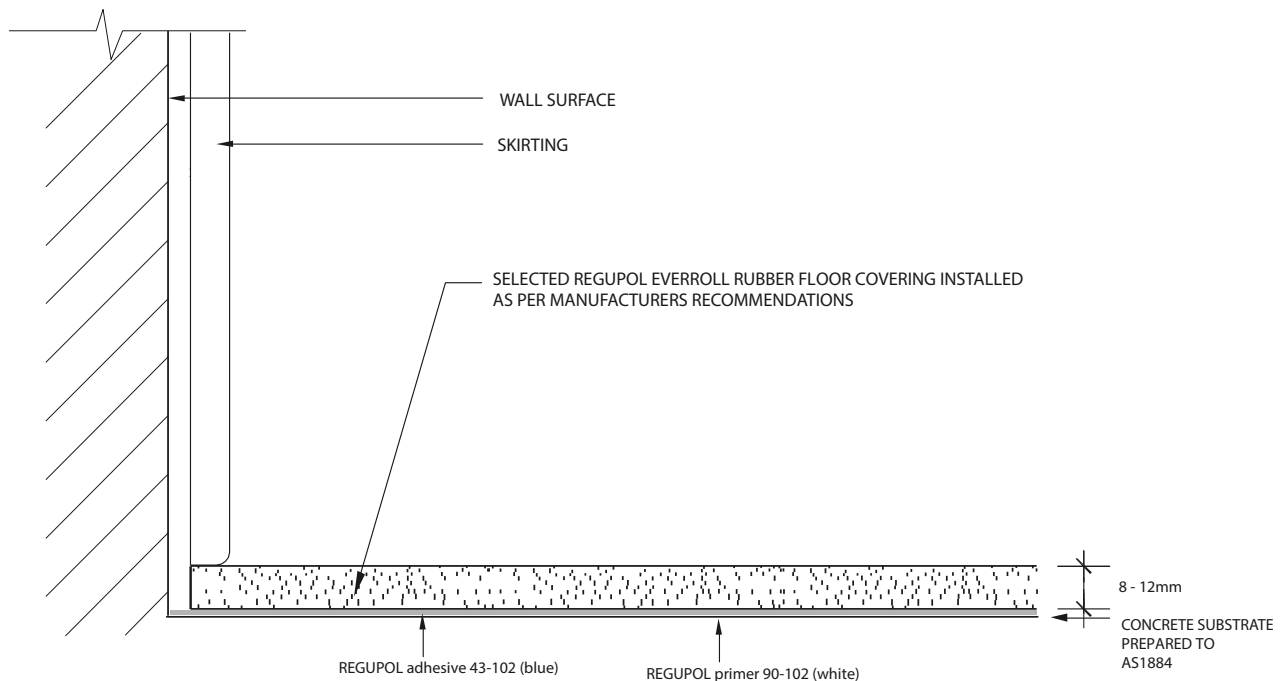
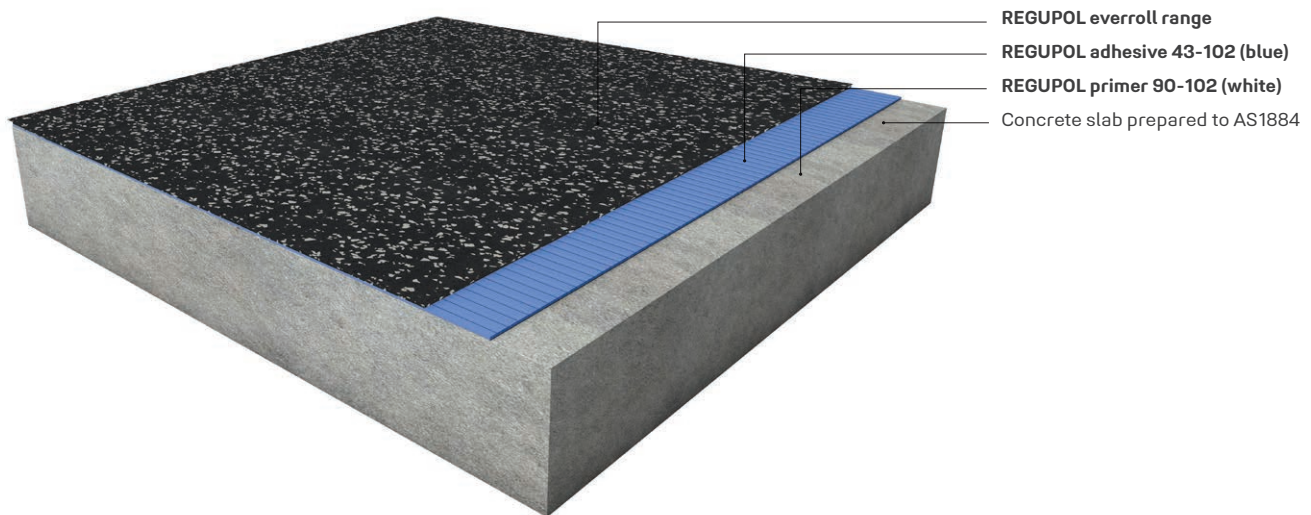

**DISCLAIMER:** The above information is given in good faith as a suggested guide in specifying REGUPOL everroll rubber flooring, no guarantee or warranty is expressed or implied. Any circumstances not covered by this guide should be referred to REGUPOL Australia or its Distributors for any particular attention required. There are, however, many factors that may affect the outcome of projects using our products that are beyond our control. REGUPOL Australia Pty. Ltd. cannot be responsible for poor climate conditions, inadequate surface preparation, poor application techniques, not observing curing times, improper thinning of adhesives or any variable beyond our control. No liability is accepted by REGUPOL Australia Pty. Ltd., our employees, distributors, representatives or agents, for any loss or damage, direct or indirect, that may result from using the information and/or suggestions as actual conditions for use that are beyond our control. All materials should be checked/tested for their suitability to the prevailing site conditions.

# FREE WEIGHT TRAINING AREAS

This system reflects a typical application with **REGUPOL everroll impact** floor coverings. For all other applications please contact the **REGUPOL** sports division. Please note that drawings are not to scale and are for illustration purposes only.

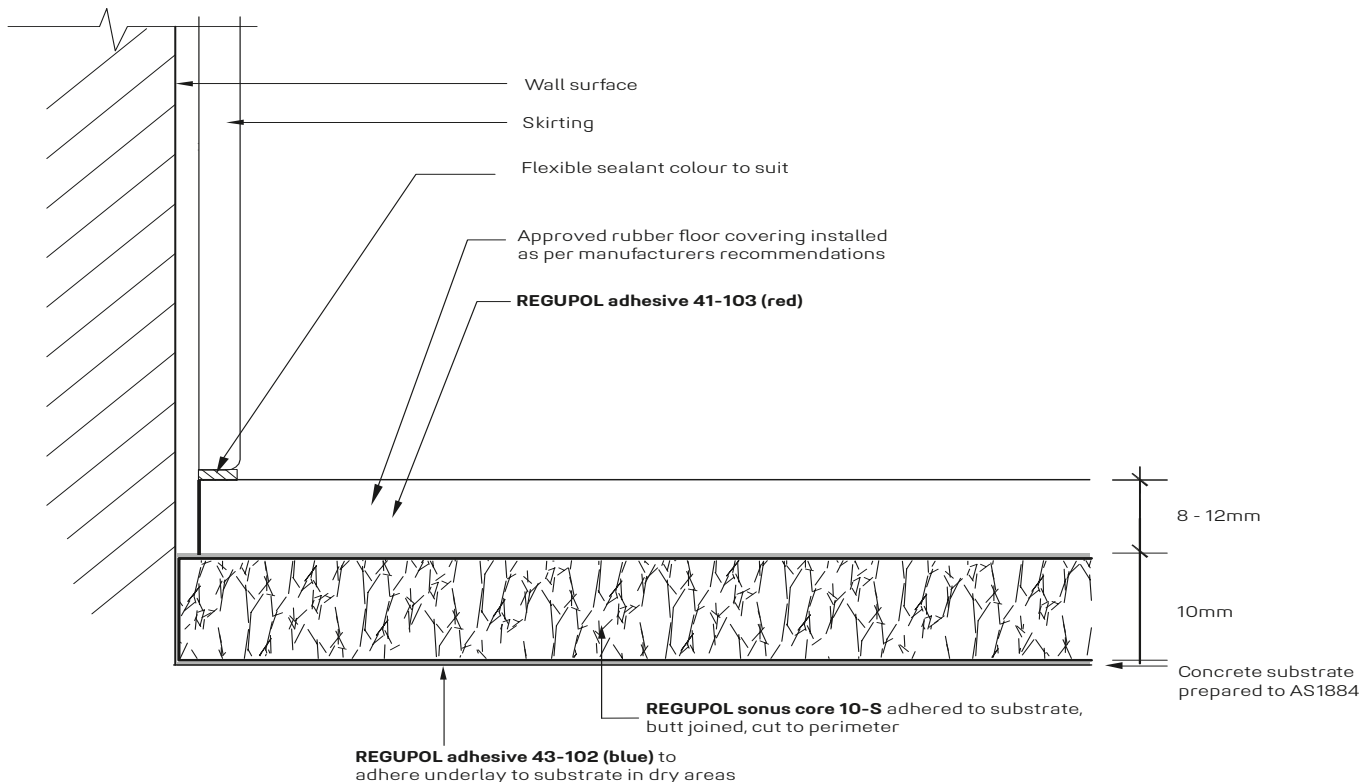
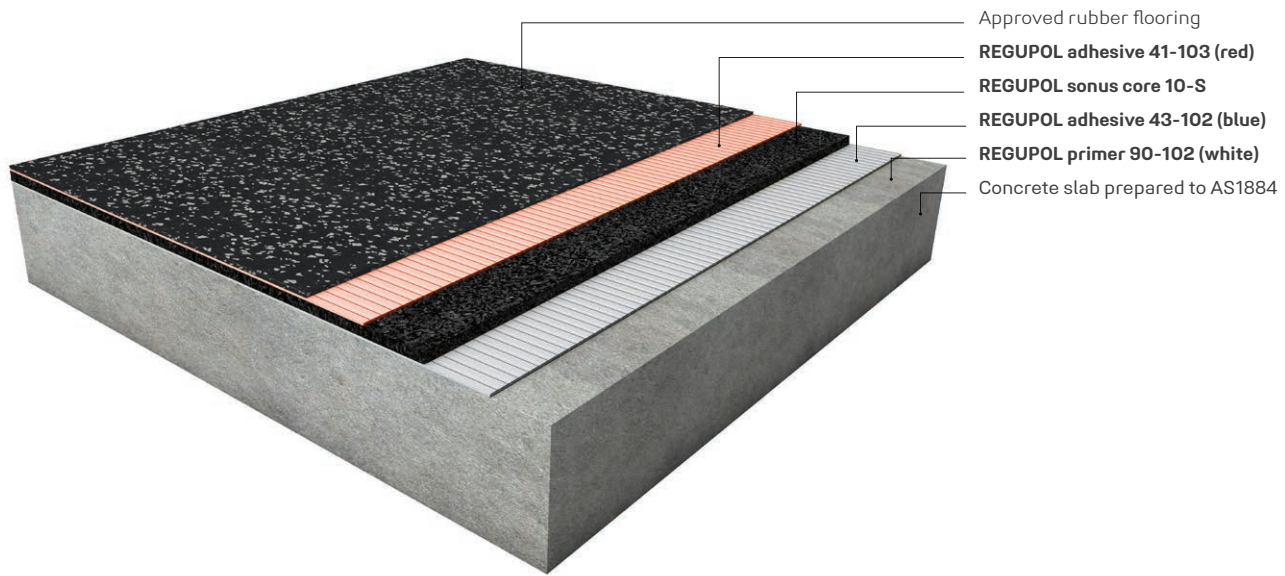

**DISCLAIMER:** The above information is given in good faith as a suggested guide in specifying REGUPOL everroll rubber flooring, no guarantee or warranty is expressed or implied. Any circumstances not covered by this guide should be referred to REGUPOL Australia or its Distributors for any particular attention required. There are, however, many factors that may affect the outcome of projects using our products that are beyond our control. REGUPOL Australia Pty. Ltd. cannot be responsible for poor climate conditions, inadequate surface preparation, poor application techniques, not observing curing times, improper thinning of adhesives or any variable beyond our control. No liability is accepted by REGUPOL Australia Pty. Ltd., our employees, distributors, representatives or agents, for any loss or damage, direct or indirect, that may result from using the information and/or suggestions as actual conditions for use that are beyond our control. All materials should be checked/tested for their suitability to the prevailing site conditions.



**REGUPOL Australia Pty. Ltd.**

155 Smeaton Grange Road  
Smeaton Grange NSW 2567  
phone +61 2 4624 0050  
rubbersales@regupol.com.au

**REGUPOL Germany GmbH & Co. KG**

**REGUPOL America LLC**

**REGUPOL Acoustics Middle East FZE**

**REGUPOL Schweiz AG**

**REGUPOL Zebra Athletics LLC**

**BSW Shanghai CO. LTD.**

[www.regupol.com.au](http://www.regupol.com.au)